

## METRIC Male Straight

## 4 Spiral Fittings

**Din Metric 24° Cone Straight**  
**Standard - Din EN ISO 8434-1**  
**O-ring - NBR**  
**Light series - FDLO**  
**Heavy series - FDHO**  
**Used for hose type -**  
**4SP, 4SH, R12, R13\*, R15\***

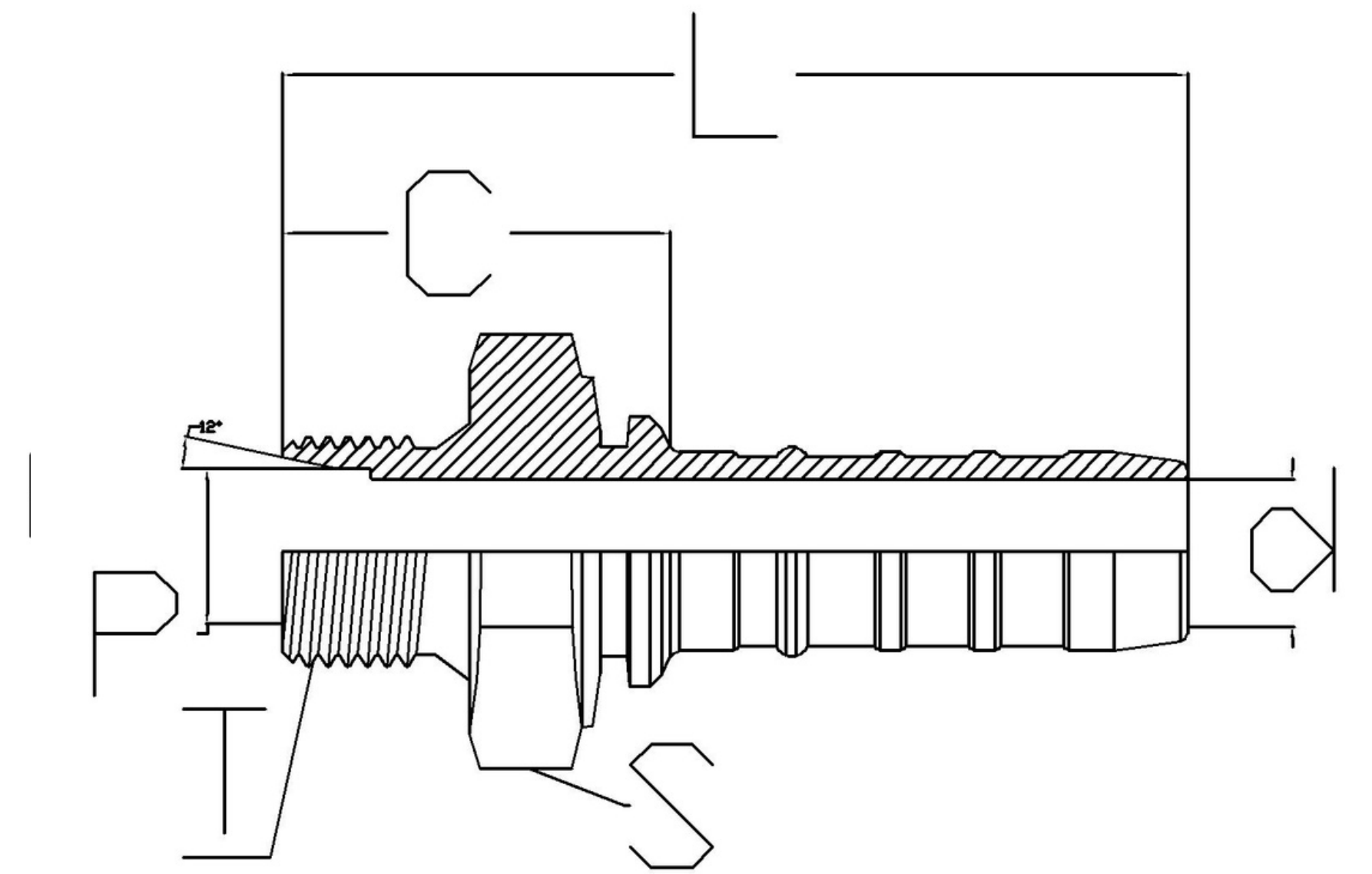

DESCRIPTION	HOSE ID (DASH)	HOSE ID (inch)	Thread (T)	S	L	C	d	D
HS-0812-MDH	8	1/2	20X1.5	36	68	31	10	34
HS-0816-MDH	8	1/2	24X1.5	36	71	34	9	34
HS-1016-MDH	10	5/8	24X1.5	36	82	32	12	42
HS-1020-MDH	10	5/8	30X2.0	32	87	36	12	42
HS-1220-MDH	12	3/4	30X2.0	32	88	38	14	46
HS-1222-MDL	12	3/4	30X2.0	32	86	36	14	46
HS-1225-MDH	12	3/4	36X2.0	41	92	42	14	46
HS-1628-MDL	16	1	36X2.0	41	100	43	20	52
HS-1630-MDH	16	1	42X2.0	46	105	47	20	52
HS-2035-MDL	20	1 - 1/4	45X2.0	46	115	44	25	62
HS-2442-MDL	24	1 - 1/2	52X2.0	55	121	48	32	72

\*\* If part number contains FBO, the fitting is with O-Ring and if it contains FB, it is without O-Ring

\* R13, R15 are only upto 1" size (for higher sizes go to section 6 spiral fittings)