

METRIC Female Straight with O-Ring

4 Spiral Fittings

Din Metric 24° Cone Female Straight
Standard - Din EN ISO 8434-1
O-ring - NBR
Light series - FDLO
Heavy series - FDHO
Used for hose type -
4SP, 4SH, R12, R13*, R15*

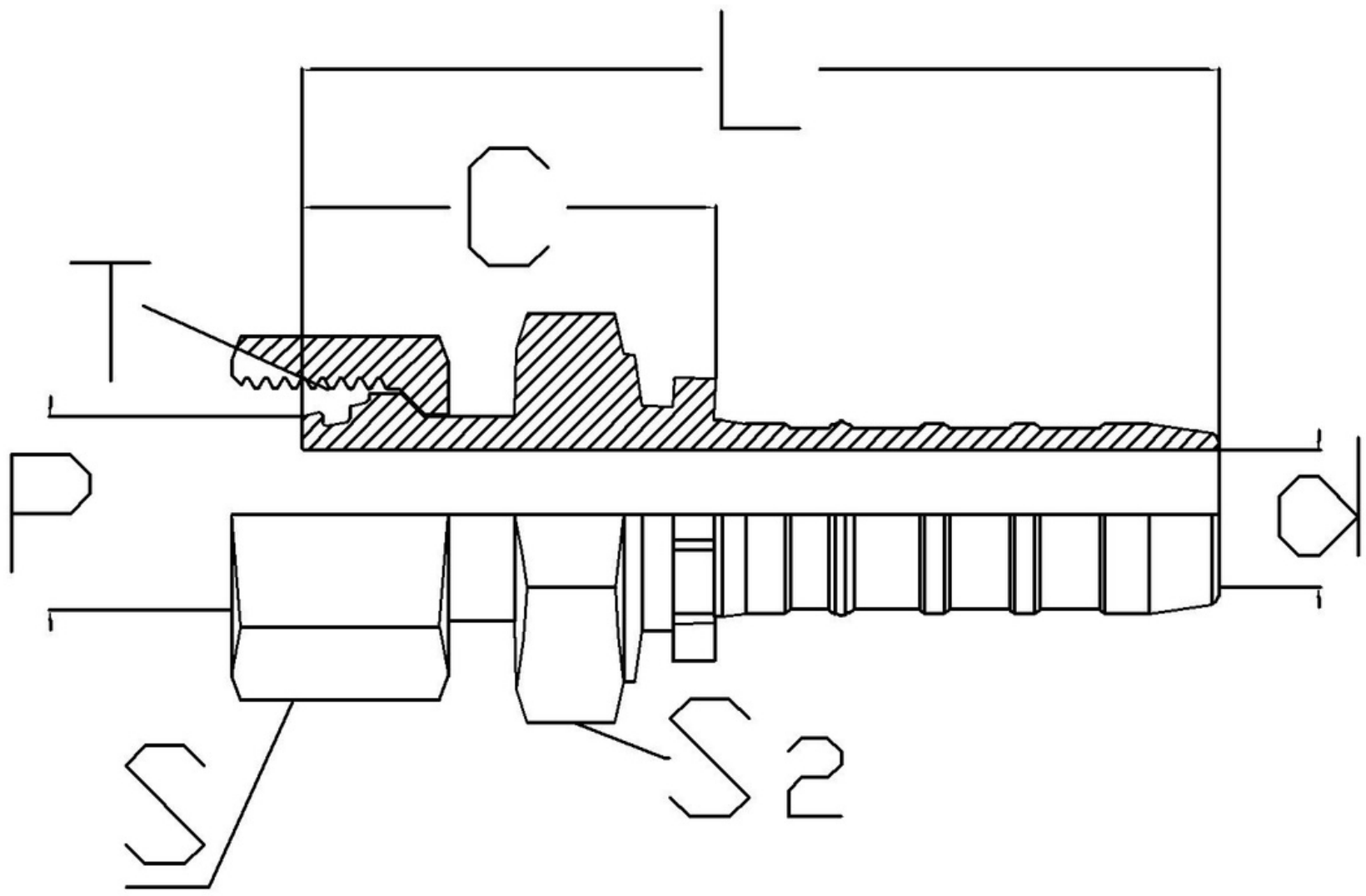

DESCRIPTION	HOSE ID (DASH)	HOSE ID (inch)	Thread (T)	S	L	C	d	D	H	S2
HS-0612-FDHO	6	3/8	12H	20X1.5	24	73	31	7	32	19
HS-0612-FDLO	6	3/8	12L	18X1.5	22	67	32	7	32	19
HS-0815-FDLO	8	1/2	15L	22X1.5	27	75	32	9	34	27
HS-0816-FDHO	8	1/2	16H	24X1.5	30	75	32	10	34	27
HS-0818-FDLO	8	1/2	18L	26X1.5	32	67	29	10	34	27
HS-1016-FDHO	10	5/8	16H	24X1.5	30	92	41	11	42	30
HS-1018-FDLO	10	5/8	18L	26X1.5	32	91	34	13	42	30
HS-1020-FDHO	10	5/8	20H	30X2.0	36	100	42	13	42	30
HS-1218-FDLO	12	3/4	18L	26X1.5	32	89	38	12	46	32
HS-1220-FDHO	12	3/4	20H	30X2.0	36	103	45	13	46	32
HS-1222-FDLO	12	3/4	22L	30X2.0	36	95	43	15	46	32
HS-1225-FDHO	12	3/4	25H	36X2.0	41	107	48	16	46	32
HS-1228-FDLO	12	3/4	28L	36X2.0	41	100	55	15	46	32
HS-1625-FDHO	16	1	25H	36X2.0	41	116	53	19	52	41
HS-1628-FDLO	16	1	28L	36X2.0	41	42	43	21	52	41
HS-1630-FDHO	16	1	30H	42X2.0	50	118	62	18	52	41
HS-2030-FDHO	20	1 - 1/4	30H	42X2.0	50	135	53	21	62	50
HS-2035-FDLO	20	1 - 1/4	35L	45X2.0	50	134	51	27	62	50
HS-2038-FDHO	20	1 - 1/4	38H	52X2.0	60	142	61	26	62	50
HS-2042-FDLO	24	1 - 1/2	42L	52X2.0	60	133	58	26	62	55
HS-2438-FDHO	24	1 - 1/2	38H	52X2.0	60	146	63	26	72	55
HS-2442-FDLO	24	1 - 1/2	42L	52X2.0	60	141	58	43	72	55

** If part number contains FBO, the fitting is with O-Ring and if it contains FB, it is without O-Ring
* R13, R15 are only upto 1" size (for higher sizes go to section 6 spiral fittings)