

Standard - ISO -8434-2

Cone - 37°

Used for hose type -

4SP, 4SH, R12, R13*, R15*

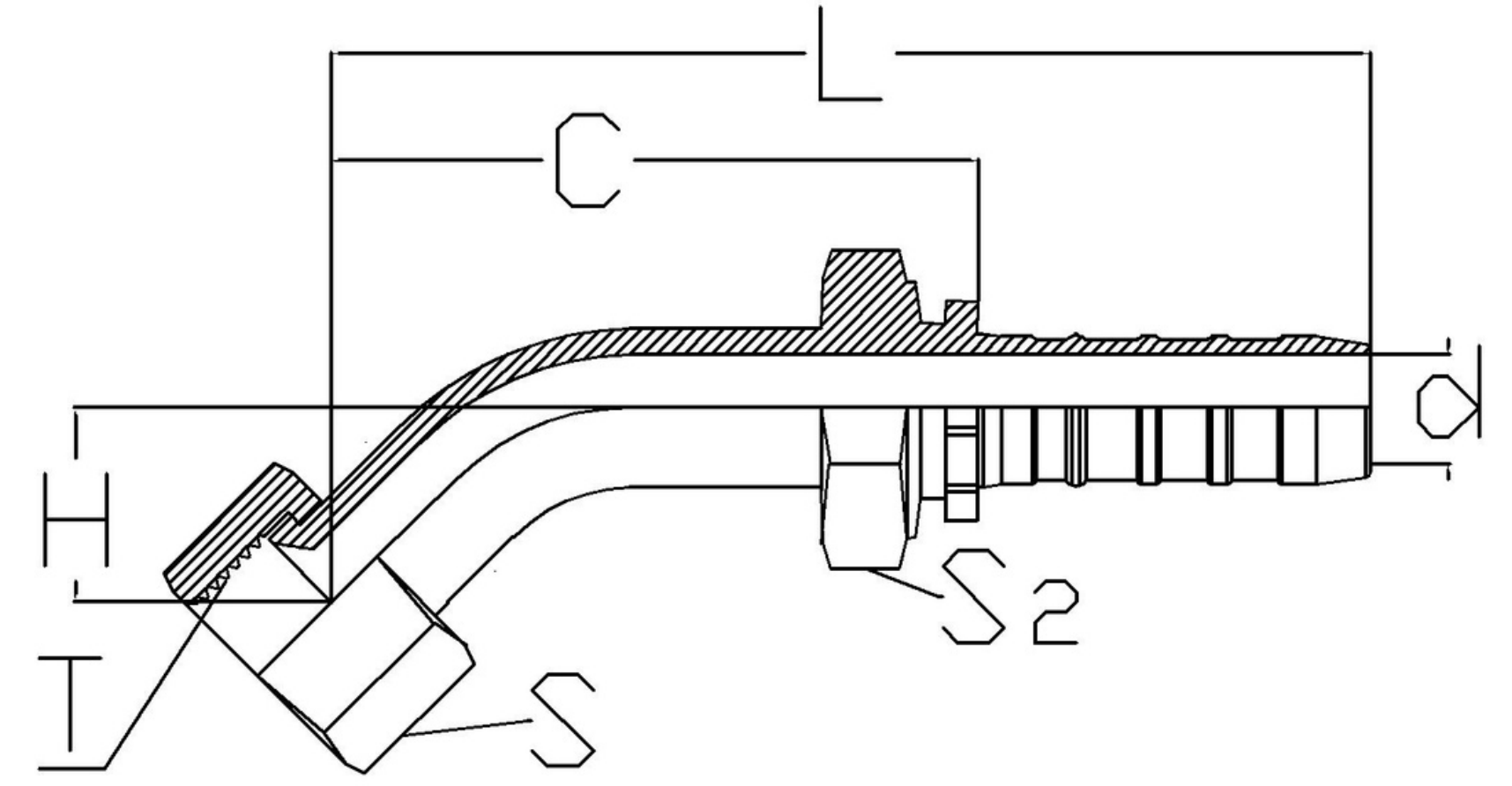

DESCRIPTION	HOSE ID (DASH)	HOSE ID (inch)	Thread (T)	S	L	C	d	D	H	S2
HS-0606-FJ-45-15	6	3/8	9/16-18UN	19	80	43	7	32	15	19
HS-0608-FJ-45-17	6	3/8	3/4-16UN	24	84	47	7	32	17	19
HS-0808-FJ-45-17	8	1/2	3/4-16UN	24	93	55	9	34	17	27
HS-0810-FJ-45-18	8	1/2	7/8-14UN	27	94	57	9	34	18	27
HS-1010-FJ-45-22	10	5/8	7/8-14UN	27	120	70	12	42	22	30
HS-1012-FJ-45-22	10	5/8	1.1/16-12UN	32	120	70	12	42	22	30
HS-1212-FJ-45-27	12	3/4	1.1/16-12UN	32	133	82	14	46	27	32
HS-1216-FJ-45-31	12	3/4	1.5/16-12UN	41	138	87	14	46	31	32
HS-1616-FJ-45-30	16	1	1.5/16-12UN	41	152	96	20	52	30	41
HS-1620-FJ-45-72	16	1	1.5/8-12UN	50	144	88	20	52	72	41
HS-2020-FJ-45-44	20	1 - 1/4	1.5/8-12UN	50	198	126	25	62	44	50
HS-2424-FJ-45-53	24	1 - 1/2	1.7/8-12UN	60	220	147	32	72	53	55
HS-3232-FJ-45-66	32	2	2.1/2-12UN	75	281	186	42	85	66	70

** If part number contains FBO, the fitting is with O-Ring and if it contains FB, it is without O-Ring

* R13, R15 are only upto 1" size (for higher sizes go to section 6 spiral fittings)